



GOZZO 48 CABIN APREAMARE



GOZZO 48 CABIN

BUILDER : Apreamare

MODEL : Gozzo 48 Cabin

PROPULSION : 2 X Volvo D8-600 Shaft Drive / 2 X Volvo IPS 700/800

LENGTH: 14.70 M

WIDTH : 4.70 M

CABINS: 2 / 3

Gozzo 48 Cabin – Apreamare's New Icon

The new Gozzo 48 Cabin by Apreamare is the ultimate expression of Mediterranean elegance. As the flagship of the Gozzo range, it combines Italian craftsmanship, spacious comfort, and modern performance.

With its walkaround deck, dual sunbathing areas, and a bright, refined interior, the Gozzo 48 Cabin offers exceptional livability. The layout includes 2 or 3 cabins, two bathrooms, and a fully equipped galley — ideal for longer stays aboard.

Powered by Volvo IPS 700/800 or shaft-drive engines, and designed with a deep-V hull by Umberto Tagliavini, this yacht ensures safe, agile, and fuel-efficient cruising.

Rooted in Apreamare's 170 years of tradition, the Gozzo 48 Cabin is built for owners who seek authentic design, comfort, and timeless style at sea.

PRICE from 950 000 € Vat not paid































































SPECIFICATIONS

BUILDER : Apremare	CRUISE SPEED : 25 Kt
MODEL : Gozzo 48 Cabin	MAX SPEED : 31 Kt
HULL : GRP	MAX GUESTS CAPACITY : 12
LENGTH : 14.70 M	MAX GUESTS SLEEPING : 4 or 6
BEAM : 4.70 M	CONSUMPTION : 125 L / H @ 25 Knots - 5 L/NM
DRAFT : 1.40 M	AUTONOMY : 320 NM
NAVIGATION CLASS : B	FUEL TANK CAPACITY : 1600 L
DRY WEIGHT : 14 T	WATER TANK : 400 L
GUESTS CABINS : 2 or 3	BLACK WATER TANK: 77 L

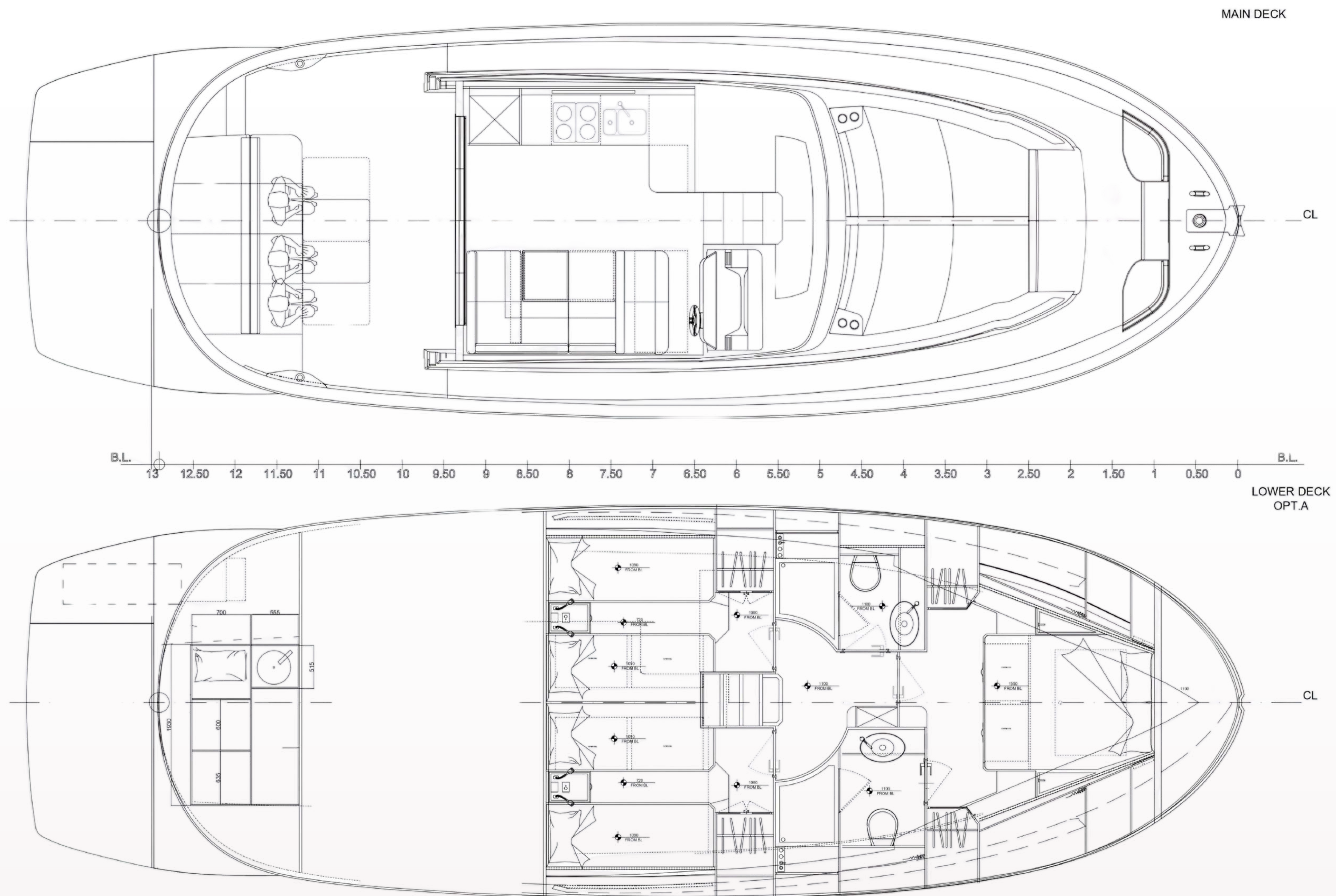

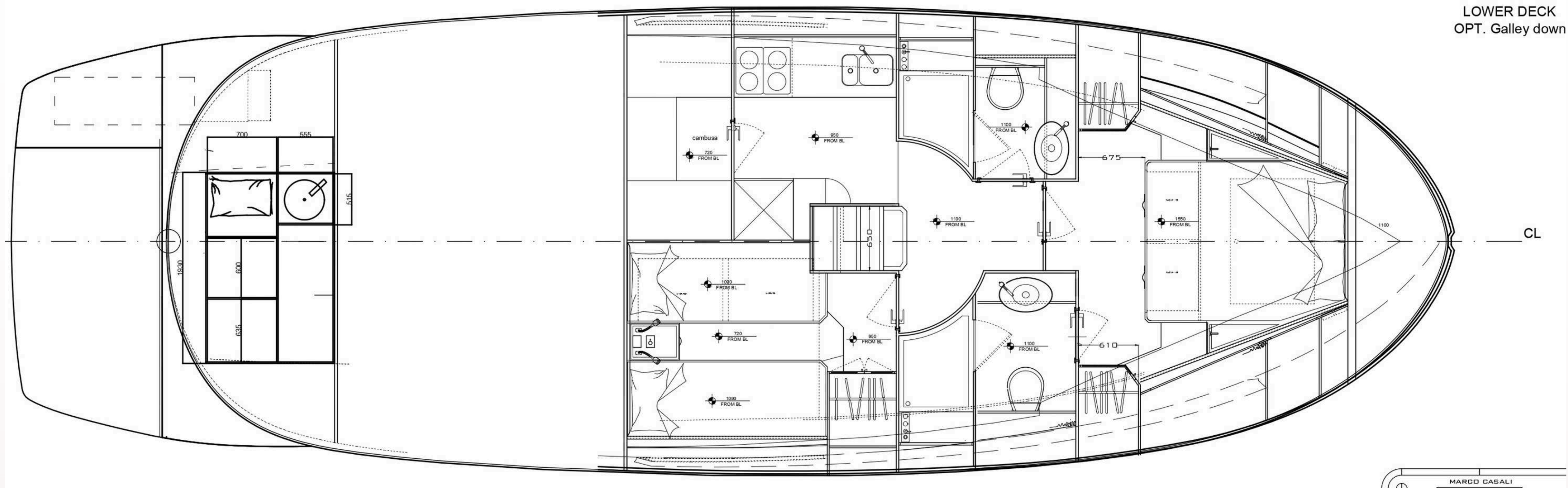
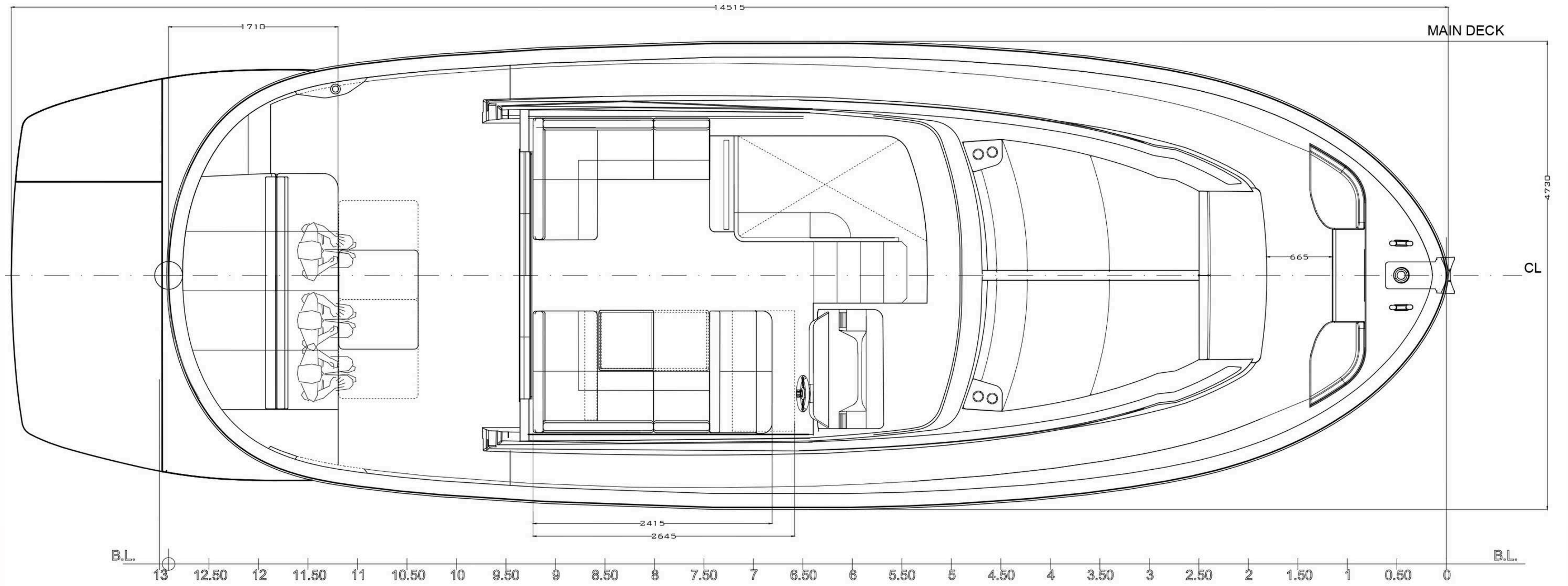



Aquila yachting
29 Port Camille Rayon 06220 Golfe Juan FRANCE
www.aquilayachting.com

Contact: +33(0)6 10 27 79 66
Mail: sales@aquilayachting.com

